



## High Dock Bumper Back Plate Left 750L x 400W x 100H

Product SKU: 6010913

*Collection of back plates used to secure the dock bumpers along walls or dock levellers.*

Back plates help improve the structural integrity of the dock bumper whilst making assembly much easier. It is highly recommended to secure the dock bumper with a backing plate. The 3-part set, high visibility and slimline dock bumpers are sold with the back plate included. Please contact our friendly sales team for the best advice according to your application.

**Colour: Silver**

**Material: Steel**

**Weight: 34KG**

**Operating temperature range: -15°C to 70°C**



## High Dock Bumper Back Plate Right 750L x 400W x 100H

Product SKU: 6010914

*Collection of back plates used to secure the dock bumpers along walls or dock levellers.*

Back plates help improve the structural integrity of the dock bumper whilst making assembly much easier. It is highly recommended to secure the dock bumper with a backing plate. The 3-part set, high visibility and slimline dock bumpers are sold with the back plate included. Please contact our friendly sales team for the best advice according to your application.

**Colour: Silver**

**Material: Steel**

**Weight: 34KG**

**Operating temperature range: -15°C to 70°C**

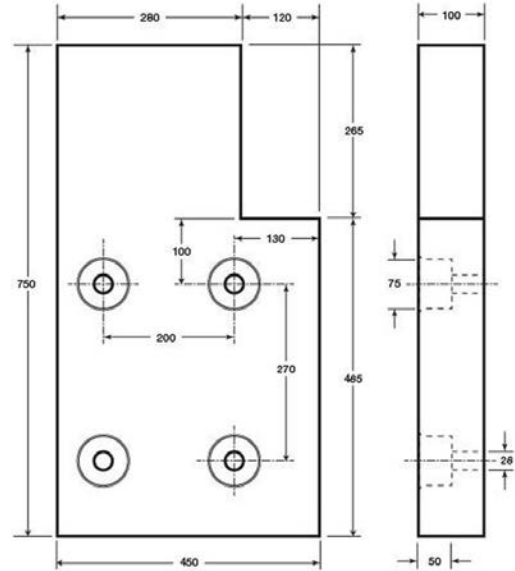

## High Top Dock Bumper Front Plate Left Steel 750L x 400W x 100H

Product SKU: 6009627

*Collection of front plates that can be attached to help improve the endurance of the dock bumper.*

Attaching a front plate to the dock bumper significantly increases its durability and performance over time. There are different varieties to suit different sized bumpers. The 3-part set, high visibility and slimline dock bumpers are sold with the front plate included. Please contact our friendly sales team for the best advice according to your application.

**Colour: Black**

**Material: Steel**

**Weight: 36KG**

**Operating temperature range: -15°C to 70°C**

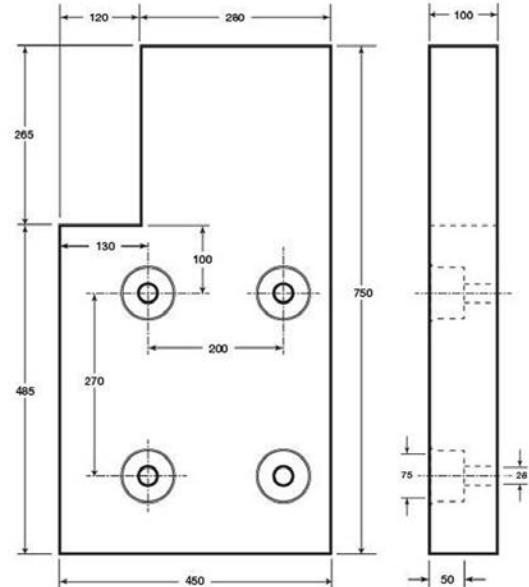

## High Top Dock Bumper Front Plate Right Steel 750L x 400W x 100H

Product SKU: 6009628

*Collection of front plates that can be attached to help improve the endurance of the dock bumper.*

Attaching a front plate to the dock bumper significantly increases its durability and performance over time. There are different varieties to suit different sized bumpers. The 3-part set, high visibility and slimline dock bumpers are sold with the front plate included. Please contact our friendly sales team for the best advice according to your application.

**Colour: Black**

**Material: Steel**

**Weight: 36KG**

**Operating temperature range: -15°C to 70°C**

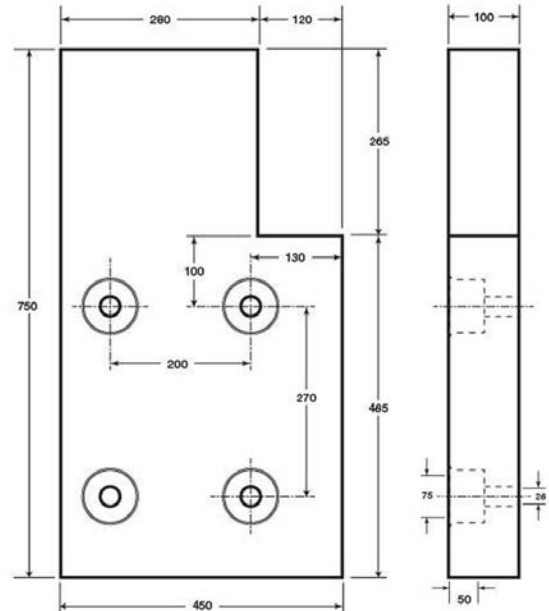

## High Top Dock Bumper Left 750L x 400W x 100H

Product SKU: 6009406

Designed to offer better protection to the top of the dock leveller or loading bay. Available left and right handed.

Where a standard sized dock bumper is not enough to protect the dock leveller or loading bay from overriding trailers. This design features an extra 400mm height on top of the bumper to provide better protection. The left and right design helps the vehicle correctly line up with the bay. There is a stainless-steel front plate available for this design to improve durability and resistance.

**Colour:** Black

**Material:** SBR/NR

**Weight:** 35KG

**Operating temperature range:** -15°C to 70°C

Physical Property	Unit	Typical Values
Hardness	ShA	75
Elongation at Break	%	200
Tensile Strength	MPa	4

Although the technical details and recommendations made correspond to the best of our knowledge and experience, all the above information must, in every case, be taken as merely indicative and subject to confirmation after long-term practical application; for this reason, anyone who intends to use Polymax products must ensure beforehand that it is suitable for the envisaged application. In every case, the user alone is fully responsible for any consequences deriving from the use of the product. All sales subject to our standard terms [www.polymax.co.uk/sales-terms](http://www.polymax.co.uk/sales-terms)

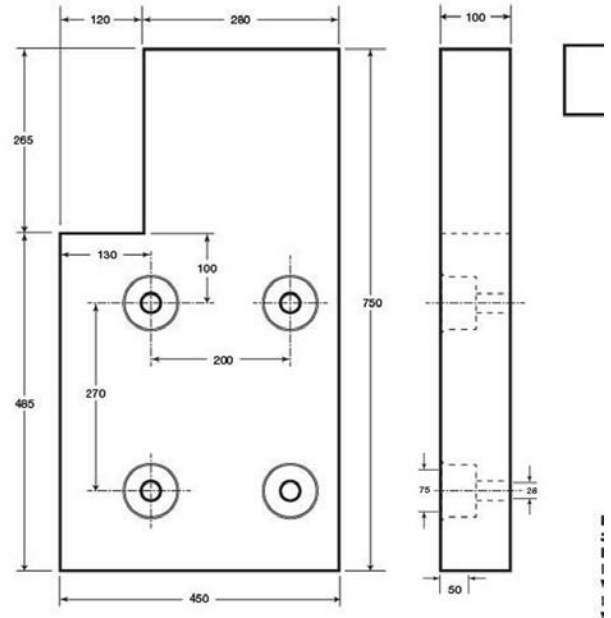

## High Top Dock Bumper Right 750L x 400W x 100H

Product SKU: 6009408

Designed to offer better protection to the top of the dock leveller or loading bay. Available left and right handed.

Where a standard sized dock bumper is not enough to protect the dock leveller or loading bay from overriding trailers. This design features an extra 400mm height on top of the bumper to provide better protection. The left and right design helps the vehicle correctly line up with the bay. There is a stainless-steel front plate available for this design to improve durability and resistance.

**Colour:** Black

**Material:** SBR/NR

**Weight:** 35KG

**Operating temperature range:** -15°C to 70°C

Physical Property	Unit	Typical Values
Hardness	ShA	75
Elongation at Break	%	200
Tensile Strength	MPa	4

Although the technical details and recommendations made correspond to the best of our knowledge and experience, all the above information must, in every case, be taken as merely indicative and subject to confirmation after long-term practical application; for this reason, anyone who intends to use Polymax products must ensure beforehand that it is suitable for the envisaged application. In every case, the user alone is fully responsible for any consequences deriving from the use of the product. All sales subject to our standard terms [www.polymax.co.uk/sales-terms](http://www.polymax.co.uk/sales-terms)